

SMART KEEPER

Essential Series User Guides



Table of Contents



Lock Key Essential	3	Lock Key Mini.....	16
USB Type A Port Lock	4	USB Type C Port Lock.....	17
RJ45 Port Lock	5	USB Type B Port Lock.....	18
LAN Cable Lock 2.....	6	HDMI Port Lock.....	19
USB Cable Lock.....	8	Display Port Lock	20
Keyboard Mouse Lock	10	SD Port Lock.....	21
Lockable Flash Drive	12	CF Port Lock.....	22
Smart Data Blocker.....	14	Mini Display Port Lock	23
		Micro USB Type B Port Lock.....	24
		Mini USB Type B Port Lock.....	26
		RJ11 Port Lock	28
LAN Cable Grip	29		
Network Module Lock.....	30		
Link Lock Hub	32		
DB-9 Serial Port Lock.....	33		
DB-25 Parallel Port Lock	34		
DVI Port Lock.....	35		
PC Lock (Key Type)	36		
PC Lock (Combination Type).....	38		
Laptop Lock	40		
USB Closing Lock	42		

Lock Key Essential (U03) User Guide

Installation



STEP 1

To expose the Key Header, slide the cover until you hear it 'click'.

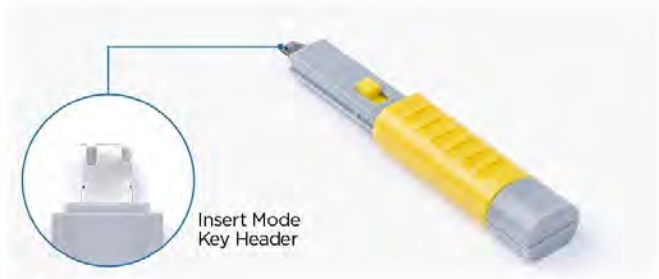

STEP 2

Insert mode

Press the button forward to put the key into insert mode before engaging or releasing the lock.

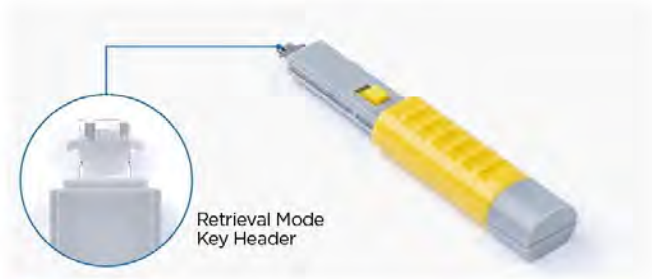

STEP 3

Retrieval mode

Pull the button back while the Key Header is inserted into the lock to engage. Once engaged, the lock can be removed.

⚠ Please Note

- Make sure the key is carefully and fully engaged before removing lock.
- When sliding the cover, be careful not to pinch your hand.
- Please note that keys and locks are matched by color.

USB Type A (UL03) User Guide

Installation



STEP 1

Insert the USB Port Lock by hand by pressing inward with your fingers.



STEP 2

Installation is complete.

Uninstall (Removal)



STEP 1

Insert the key into the key slot at the bottom of port lock with the button on the key facing upward.



STEP 2

Press the button of the key backward to engage the lock for removal.



STEP 3

Pull out the key to remove port lock from the port.



STEP 4

Press the button of the key forward to release the lock from the key.

! Please Note

- Keys and locks are matched by color.
- During removal, if the lock catches on the surrounding frame, please apply pressure in the opposing direction as you pull it out.
- Make sure the key is carefully and fully engaged before removing lock.
- When sliding the cover, be careful not to pinch your hand.

RJ45 (NL03) User Guide

Installation



STEP 1

The RJ45 Port Lock can be installed only while in **Unlocked Position**. Insert by holding the sides so that it does not go into Locked Position during installation



STEP 2

As illustrated, press the front part of RJ45 Port Lock to lock it into the port.

Uninstall (Removal)



STEP 1

Insert the key into the key slot of the port lock with the button on the key facing upward.



STEP 2

Press the button of the backward to engage the lock for removal and pull out the key.



STEP 3

Press the button of the key forward to release the port lock from the key.

! Please Note

- Keys and locks are matched by color.
- In case the lock is in closed position, use the Lock Key to open. Insert the key, slide the button back and gently pull the key to open.
- Make sure the key is carefully and fully engaged before removing lock.
- When sliding the cover, be careful not to pinch your hand.

LAN Cable Lock 2 (NC13) User Guide



Lock Button

Remove RJ45 boots first (if necessary)

For non-movable boots: Remove the upper portion of boot by using a cutter, then install a LAN Cable Lock 2.



For movable boots: Move it back to clear space, then install a LAN Cable Lock 2.



Installation

Insert the ethernet cable into the LAN Cable Lock 2 (left image), then move and attach it to the RJ45 connector (right image).



Lock the LAN Cable Lock 2 by pressing the lock button in completely.



Uninstall (Removal)

Move Lock Key sliding button forward in place: Moving position (Refer to Lock Key Essential U03 User Guide).



After inserting the Lock Key and moving into retrieval position, pull out the Lock Key with the lock attached.

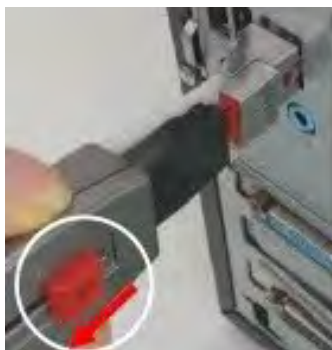

The bottom of the RJ45 connector is connected to the jaws of the LAN Cable Lock 2. To separate, pull it down.

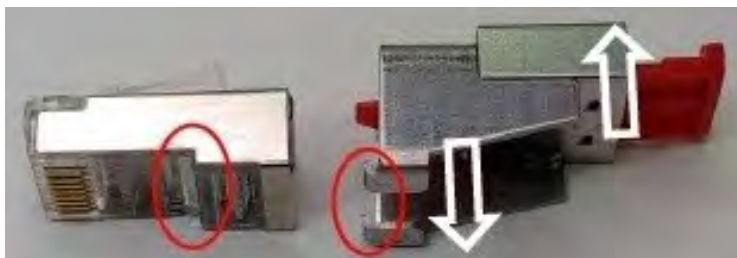

After unlocking the LAN Cable Lock 2, tilt the lock button forward (1), then pull it back to remove it (2).



⚠ Please Note

- Keys and locks are matched by color.
- Make sure the key is carefully and fully engaged before removing lock.
- When sliding the cover, be careful not to pinch your hand.

USB Cable Lock (LK03) User Guide

Installation



STEP 1

Insert the USB Cable through the cover and into the port on the cable lock.



STEP 2

Take care to maintain proper orientation.



STEP 3

Push the cover forward until it fits securely against the cable.



STEP 4

Insert the Cable Lock into the USB port.



STEP 5

Press the lock button on the Cable Lock to complete the installation.



STEP 6

Installation is complete

Uninstall (Removal)



STEP 1

Insert the key into the key slot at the bottom of port lock with the button on the key facing upward.



STEP 2

Press the button of the key backwards to engage the lock for removal and pull out the key.



STEP 3

Press the button of the key forward to release the lock from the key.



STEP 4

Release the USB Cable Lock by hand.

! Please Note

- Keys and locks are matched by color.
- During removal, if the lock catches on the surrounding frame, please apply pressure in the opposing direction as you pull it out.
- Make sure the key is carefully and fully engaged before removing lock.
- When sliding the cover, be careful not to pinch your hand.

Keyboard | Mouse Lock (UM03) User Guide

Installation



STEP 1

Select a group of four USB ports in either a horizontal or vertical direction. Connect two USB cables side by side.



STEP 2

The cables are inserted through the frame, which is used to cover the inserted connectors.



STEP 3

Insert the Frame Lock into the rubber ring, which is properly aligned on the USB port. Press the lock button on the Frame Lock to complete the installation.

Uninstall (Removal)



STEP 1

Rotate the Key 180 degrees and insert it into the key slot of the Frame Lock. The key's button should be facing in the opposite direction of the Frame Lock's **SMARTKEEPER** logo.



STEP 2

Press the button of the key backward to engage the lock for removal and pull out the key.



STEP 3

Push the button of the key forward in order to release the key from the Frame Lock.



STEP 4

Release the Frame Lock, Rubber Ring and Frame by hand.

⚠ Please Note

- Keys and locks are matched by color.
- Make sure the key is carefully and fully engaged before removing lock.
- When sliding the cover, be careful not to pinch your hand.

Lockable Flash Drive (OM03) User Guide

Installation



STEP 1

Insert Lockable Flash Drive into the USB port by hand – taking note of proper alignment.



STEP 2

You can use the Lockable Flash Drive while in unlocked position.



STEP 3

Press the lock button to lock the Lockable Flash Drive into the port.

Uninstall (Removal)



STEP 1

Flip the key 180 degrees so that the button of the key is facing in the direction of the **SMARTKEEPER** logo and insert it into the key slot of the lock button.



STEP 2

Pull the key button backwards to engage. Once engaged, pull back to unlock.



STEP 3

Press the button of the key forward to release the key from the flash drive.



STEP 4

Remove the flash drive by hand.

⚠ Please Note

- Keys and locks are matched by color.
- Make sure the key is carefully and fully engaged before removing lock.
- When sliding the cover, be careful not to pinch your hand.

Smart Data Blocker (UCL03) User Guide

Installation



STEP 1

Insert the Smart Data Blocker into the port to be used.



STEP 2

Press the lock button to secure to the port. Please note that no data is transferred. The port can only be used for charging.



STEP 3

As illustrated, please take note to ensure proper cable orientation before inserting.

Uninstall (Removal)



STEP 1

Insert the key into the key slot at the bottom of Smart Data Blocker with the button on the key facing upward.



STEP 2

Pull the button of the key backwards to engage for removal. Once engaged, pull the key backwards to unlock.



STEP 3

Push the button of the key forward to release the key from the Smart data Blocker.



STEP 4

Remove the Smart Data Blocker by hand.

⚠ Please Note

- Keys and locks are matched by color.
- Make sure the key is carefully and fully engaged before removing lock.
- When sliding the cover, be careful not to pinch your hand.

Lock Key Mini (U04) User Guide

Installation



STEP 1

Slide the cover open to expose the Key Header. After rotating the cover 180 degrees, close the cover cap to secure it.



STEP 2

Insert mode

You can insert/release the key by pressing the button forward.

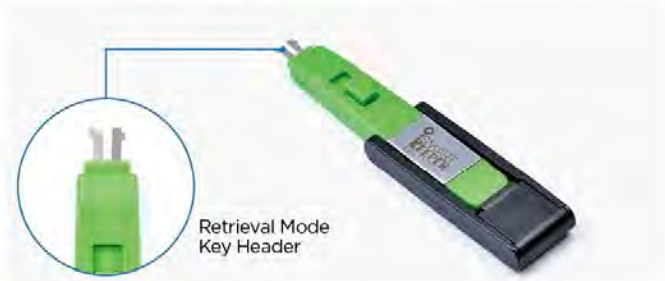

STEP 3

Retrieval mode

After the key has been inserted into the port lock, pull the button back to engage. Pull the key backward to remove the port lock.

⚠ Please Note

- Keys and locks are matched by color.
- Make sure the key is carefully and fully engaged before removing lock.
- When sliding the cover, be careful not to pinch your hand.

USB Type C (CL04) User Guide

Installation



STEP 1

The key slot in the USB-C Port Lock should be facing downwards. Insert the port lock by hand - taking note of proper alignment.



STEP 2

Installation is complete.

Uninstall (Removal)



STEP 1

Insert the key into the key slot at the bottom of the port lock with the button on the key facing upward.



STEP 2

Press the button of the key backward to engage the lock for removal and pull out the key.



STEP 3

Press the button of the key forward to release the port lock from the key.

⚠ Please Note

- Keys and locks are matched by color.
- Make sure the key is carefully and fully engaged before removing lock.

USB Type B (BL04) User Guide

Installation



STEP 1

Insert the port lock by hand – taking note of proper alignment.



STEP 2

Installation complete.

Uninstall (Removal)



STEP 1

Insert the key into the key slot at the bottom of the port lock with the button on the key facing upward. (Rotate the key 180 degrees if the port lock is installed upside down.)



STEP 2

Press the button of the key backward to engage the lock for removal and pull out the key.



STEP 3

Press the button of the key forward to release the port lock from the key.

! Please Note

- Keys and locks are matched by color.
- Make sure the key is carefully and fully engaged before removing lock.

HDMI (HMD04) User Guide

Installation



STEP 1

Insert the port lock by hand – taking note of proper alignment.

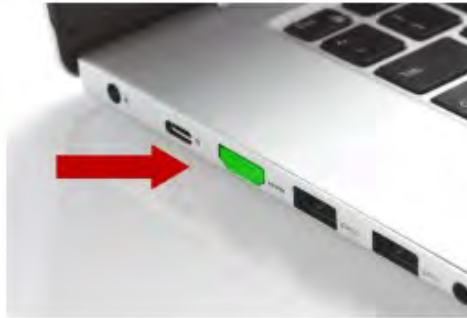

STEP 2

Installation complete.

Uninstall (Removal)



STEP 1

Insert the key into the key slot at the bottom of the port lock with the button on the key facing upward. (Rotate the key 180 degrees if the port lock is installed upside down.)



STEP 2

Press the button of the key backward to engage the lock for removal and pull out the key.



STEP 3

Press the button of the key forward to release the port lock from the key.

! Please Note

- Keys and locks are matched by color.
- Make sure the key is carefully and fully engaged before removing lock.

Display (DL04) User Guide

Installation



STEP 1

Insert the port lock by hand – taking note of proper alignment.



STEP 2

Installation complete.

Uninstall (Removal)



STEP 1

Insert the key into the key slot – which is located above the **SMARTKEEPER** logo.



STEP 2

Press the button of the key backward to engage the lock for removal and pull out the key.



STEP 3

Press the button of the key forward to release the port lock from the key.

! Please Note

- Keys and locks are matched by color.
- Make sure the key is carefully and fully engaged before removing lock.



SD (SD04) User Guide

Installation



STEP 1

Insert the SD Port Lock by hand. Make sure to match the internal shape of the port.



STEP 2

Installation is complete.

Uninstall (Removal)



STEP 1

Insert the key into the key slot of the port lock.



STEP 2

Press the button of the key backward to engage the lock for removal and pull out the key.



STEP 3

Press the button of the key forward to release the port lock from the key.

! Please Note

- Keys and locks are matched by color.
- Make sure the key is carefully and fully engaged before removing lock.

CF (CF04) User Guide

Installation



STEP 1

Insert the CF Port Lock by hand. Make sure to match the internal shape of the port.



STEP 2

Installation is complete.

Uninstall (Removal)



STEP 1

Insert the key into the key slot of the port lock.



STEP 2

Press the button of the key backward to engage the lock for removal and pull out the key.



STEP 3

Press the button of the key forward to release the port lock from the key.

! Please Note

- Keys and locks are matched by color.
- Make sure the key is carefully and fully engaged before removing lock.

Mini Display (MD04) User Guide

Installation



STEP 1

Insert the port lock by hand – taking note of proper alignment.



STEP 2

Installation complete.

Uninstall (Removal)



STEP 1

Put the key into Insert Mode and insert the key into the key slot of the port lock.



STEP 2

Press the button backwards to engage the port lock for removal. Once engaged, the lock can be pulled out.



STEP 3

Press the button of the key forward to release the port lock from the key.

⚠ Please Note

- Keys and locks are matched by color.
- Make sure the key is carefully and fully engaged before removing lock.

Micro USB Type B (MUL04) User Guide

Installation using key

- For small products, installation by key is preferred.



STEP 1

Put the key into **Insert Mode** and insert the key into the key slot of the port lock. Press the button of the key backward to engage.



STEP 2

Insert the port lock on the key into the port.



STEP 3

Press the button on the key forward to release the key from the port lock. Pull out the key to complete the installation.

Uninstall (Removal)



STEP 1

Insert the key into the key slot at the bottom of the port lock with the button on the key facing upward.



STEP 2

Press the button of the key backward to engage the lock for removal and pull out the key.



STEP 3

Press the button of the key forward to release the port lock from the key.

⚠ Please Note

- Keys and locks are matched by color.
- Make sure the key is carefully and fully engaged before removing lock.

Mini USB Type B (UL04) User Guide

Installation using key

- For small products, installation by key is preferred.



STEP 1

Put the key into **Insert Mode** and insert the key into the key slot of the port lock. Press the button of the key backward to engage.



STEP 2

Insert the port lock on the key into the port.



STEP 3

Press the button on the key forward to release the key from the port lock. Pull out the key to complete the installation.

Uninstall (Removal)



STEP 1

Insert the key into the key slot at the bottom of the port lock with the button on the key facing upward.



STEP 2

Press the button of the key backward to engage the lock for removal and pull out the key.



STEP 3

Press the button of the key forward to release the port lock from the key.

⚠ Please Note

- Keys and locks are matched by color.
- Make sure the key is carefully and fully engaged before removing lock.

RJ11 (MNL04) User Guide

Installation



STEP 1

Insert the port lock by hand – taking note of proper alignment.



STEP 2

Installation is complete.

Uninstall (Removal)



STEP 1

Insert the key into the key slot of the port lock.



STEP 2

Press the button of the key backward to engage the lock for removal and pull out the key.



STEP 3

Press the button of the key forward to release the port lock from the key.

⚠ Please Note

- Keys and locks are matched by color.
- Make sure the key is carefully and fully engaged before removing lock.

LAN Cable Grip (NCG01P1) User Guide

No Key Required

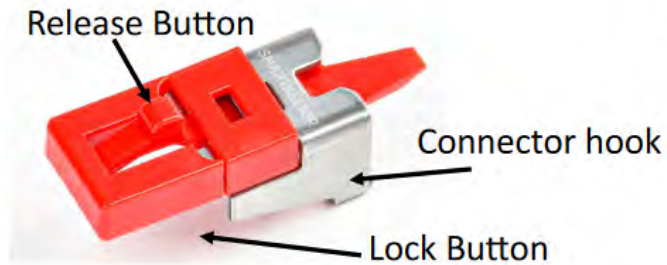

⚠ Please Note!

To install the product, remove the protective boot from the connector.

⚠ Tips!

It can be installed without disconnecting the cables already in use.

Installation



Tilt 45 degrees as the image is shown and move the LAN Cable Grip forward near the connector.



Fix the connector hook of the LAN Cable Grip with the bottom of the connector so that it is strongly attached.



Push the lock button all the way to the end to complete installation.

Removal



Slide the lock button backward while pressing the release button on the top.



Tilt the LAN Cable Grip 45 degrees so that it doesn't get caught in the cable chin and pull it backwards.



Pull out the LAN Cable Grip all the way out of the cable.

Network Module Lock (CSK-NM10) User Guide

1. How to install

1 Install the center panel



Confirm direction (see circle)

For modules in the middle, insert and move the panel from the side panel

2 Install the lower panel



Put in the lower panel from the bottom and insert to the center panel (fit to the slot)

3 Install the upper panel



4 Insert USB Port Lock



2. How to remove (also refer to Lock Key user guide)

1 Insert Lock Key (Moving Position)



2 Set retrieval position



3 Slide out



4 Remove the upper panel



5 Remove the lower panel



6 Remove the center panel



3. Installation guide for RJ-45 cables with boots

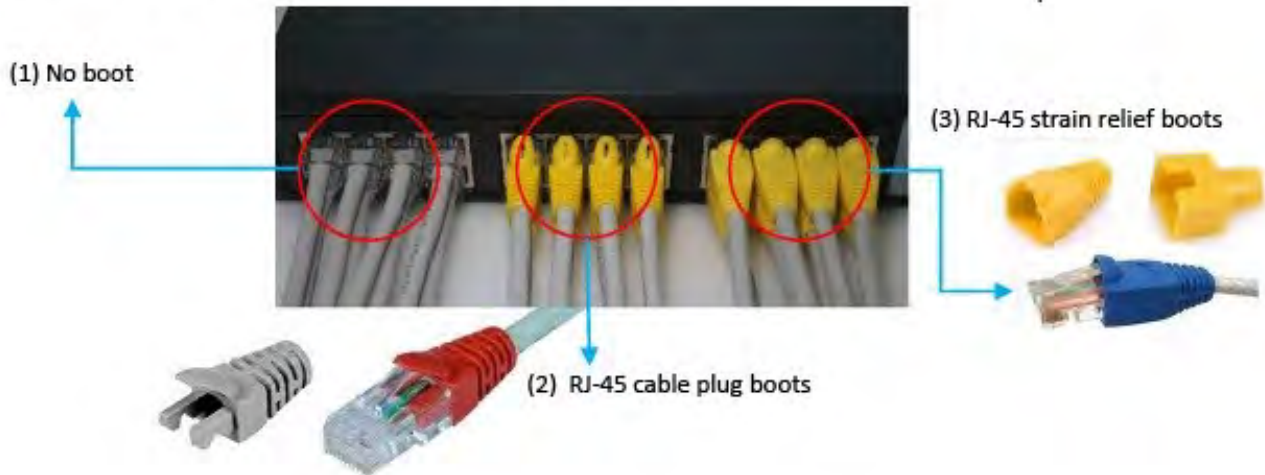

1 For (1) No boot or (2) RJ-45 cable plug boots, follow the same procedure as user guide shows (install the center panel)



2 For (3) RJ-45 strain relief boots, unlike (1) or (2) there is no space to insert a center panel. Skip inserting center panel



Link Lock Hub (CSK-LKH01) User Guide

1. How to install



1 Connect Link Lock Hub to Link Lock



2 Press Lock Button on Link Lock



3 Slide Link Lock cover in the direction of arrow



4 Lift Link Lock cover in the direction of arrow



5 Connect desired USB devices to USB hub



6 Align notch on the cover with notches on base



7 Close Link Lock cover



8 Link Lock Hub assembly now complete

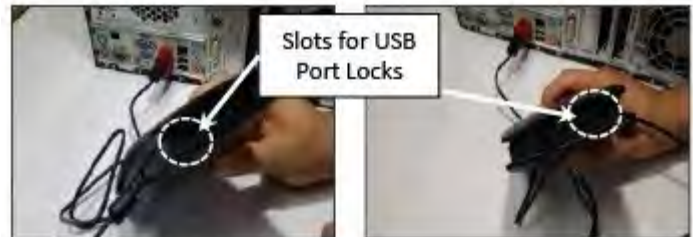

9 Identify slots for USB Port Locks on both side of hub



10 Align cover and base to install USB Port Lock



2. How to remove



1 Remove USB Port Locks on sides using Lock Key



2 Link Lock HUB now unlocked

- Link Lock HUB is used with Link Lock to secure multiple USB devices.
- Up to 4 USB devices can be connected to one Link Lock HUB.
- Connect desired USB devices to USB hub inside Link Lock HUB, put cover on and lock the Link Lock HUB using USB Port Locks.
- Designed to use same customized Lock Key for Link Lock and USB Port Lock

Serial/DB-9 (CSK-SPL10) User Guide

1. Ports this product protects



2. Notes

1) Serial Port Lock components



* USB Port Lock (CSK-UL02, CSK-UL10), sold separately

2) How to remove cover from bracket



3. How to install



- 1 Place bracket
- 2 Screw in
- 3 Replace cover



- 4 Lock is ready
- 5 Insert USB Port Lock
- 6 Serial Port Lock installed

4. How to remove



- 1 Insert Lock Key into USB Port Lock



- 2 Fully engage sliding button



- 3 Pull key/lock out of bracket



- 4 Remove cover



- 5 Unscrew
- 6 Remove bracket

Parallel/DB-25 (CSK-PL10) User Guide

1. Blocks DB-25 ports

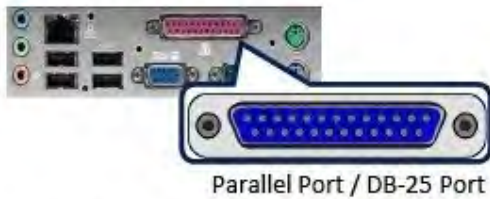

2. Contents

1) Parallel Port Lock components



* Compatible with USB Port Lock (CSK-UL02, CSK-UL10), not included and sold separately

2) How to remove a cover from the bracket



3. How to install



- 1 Place the bracket 2 Screw in 3 Place the cover



- 4 Ready to lock 5 Insert a USB Port Lock 6 Parallel Port Lock installed

4. How to remove



- 1 Insert Lock Key into the USB Port Lock



- 2 Fully extend the sliding button to engage



- 3 Pull the key out

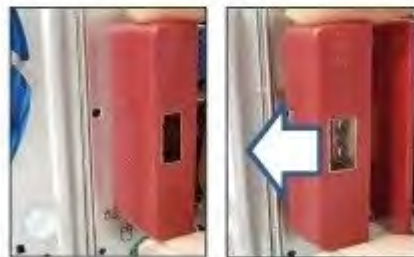

- 4 Move the cover out

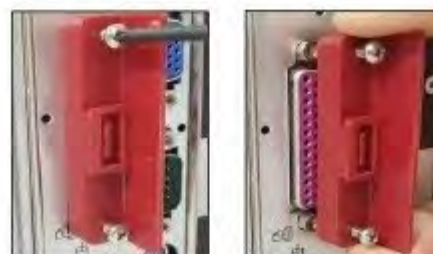

- 5 Unscrew 6 Remove the bracket

DVI (CSK-DL10) User Guide

1. Protects DVI ports

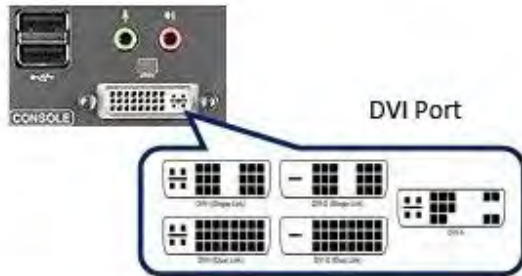

2. Contents

1) DVI Port Lock components



* USB Port Lock (CSK-UL02, CSK-UL10) sold separately

2) How to remove a cover from the bracket



3. How to install



- 1 Place bracket 2 Screw in 3 Place cover

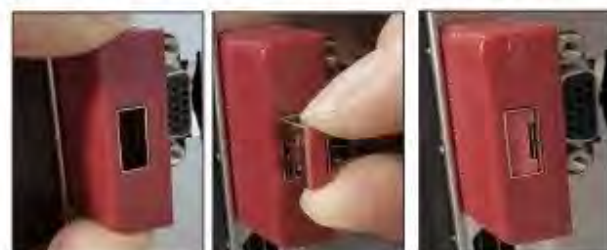

- 4 Ready to lock 5 Insert USB Port Lock 6 DVI Port Lock Installed

4. How to remove



- 1 Insert Lock Key into USB Port Lock



- 2 Move sliding button towards bracket.



- 3 Pull out key/lock



- 4 Remove cover

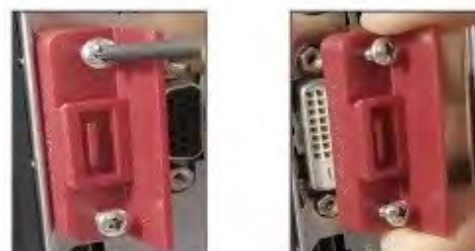

- 5 Unscrew 6 Remove bracket

PC Lock Key Type (CSK-SLD01) User Guide

Installation

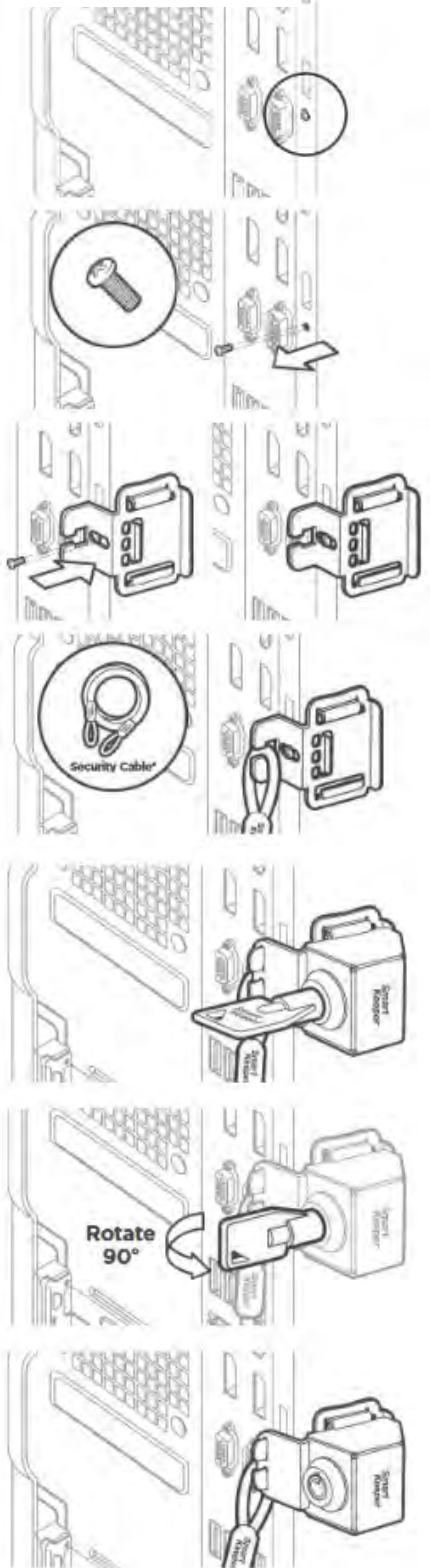

Choose a location of the screw on PC body to install PC lock.

Remove screw. ***no drilling required***

Align the bracket and reattach the screw through the opening on the bracket and tighten.

Attach the Security Cable (***optional and sold separately***) to the notch on the bracket. Skip this step if the Security Cable is not used.

Attach the PC Lock body to the bracket.

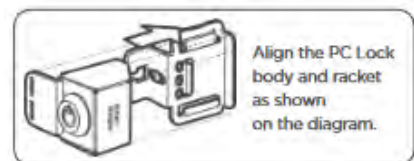

Insert the key and turn to lock.

Installation complete.

Uninstall (Removal)

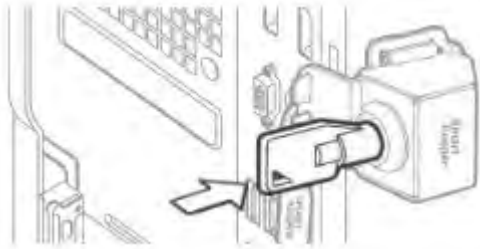

Insert Lock Key.



Turn the Lock Key and unlock.

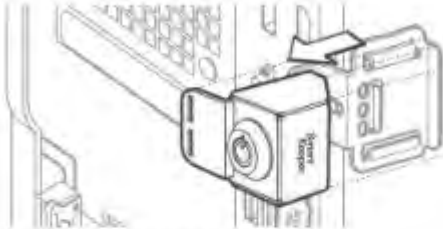

Remove the PC Lock body.

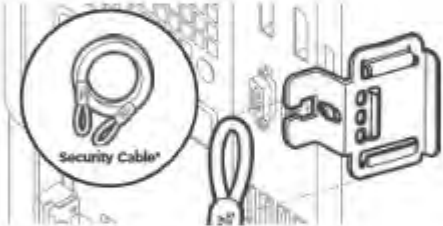

Remove the Security Cable (***optional and sold separately***). Skip this step if the Security Cable is not used.

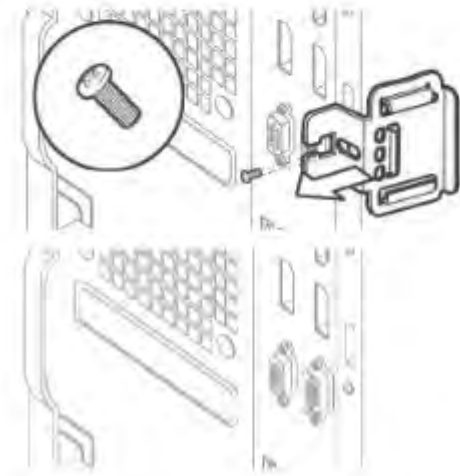

Remove the screw on the bracket.

Uninstall complete.

PC Lock Combination (CSK-SLD01) User Guide

Installation



STEP 1

Remove the screw on the side panel of the desktop computer to put the Bracket on.



STEP 2

Align the hole on the bracket with the screw hole on the side panel. Reinsert the screw and tighten to attach the Bracket.
(The space between the screw and the edge of the desktop's panel should be less than 0.63 inches.)



STEP 3

As illustrated, insert the PC Body Lock into the Bracket.



STEP 4

Once the Cable has been attached to a fixture, insert the one end of the Cable through its other end as illustrated.



STEP 5

Put the cable end on the shackle and rotate it 180 degrees towards the Bracket.



STEP 6

Press the shackle into the Bracket, rotate the dials to complete the installation.

Uninstall (Removal)



STEP 1

Rotate the dials to match the correct combination and pull the shackle out.



STEP 2

Remove the Cable from the shackle, pull the PC Lock Body out of the Bracket.



STEP 3

Remove the screw and the Bracket.



STEP 4

Put the screw back into the side panel to complete the uninstallation.

⚠ Please Note

- Initial combination is 0-0-0-0.
- Please check your desktop panel before your purchase.
(The space between the screw and the edge of the desktop's panel should be less than 0.63 inches.)
- Lost combinations CANNOT be reset. (Record and keep your combination in a safe place.)

Laptop Lock (CSK-LLD01) User Guide

Installation



STEP 1

Rotate the dials to match the correct combination. Rotate the shackle clockwise as illustrated and insert the lock into a desired USB Port.



STEP 2

Once the cable is attached to the fixture, insert one end of the cable through the other end as illustrated.



STEP 3

Put the cable into the shackle of the Laptop Lock, rotate the shackle counterclockwise until it is in proper position.



STEP 4

Press the shackle in and rotate the dials to complete the installation.

Uninstall (Removal)



STEP 1

Rotate the dials to match the correct combination before pulling the shackle out.



STEP 2

The cable can now be removed from the shackle.



STEP 3

Pull to remove the Laptop Lock from the USB port.

! Please Note

- Refer to User Guide before installation.
- Lost combinations CANNOT be reset. (Record and keep your combination in a safe place.)

USB Closing Lock (CSK-PC01) User Guide

ATTENTION: PERMANENTLY LOCKS





Insert the USB Closing Lock by hand by pressing inward with your fingers.

Please note: Once inserted it cannot be removed.

For more information visit
smartkeeper.us



 7035 Greenbrier Rd. Huntsville, AL 35756

 (256) 771 - 0660

 info@smartkeeper.us



